



**Sure Flow
Equipment Inc.**

SANITARY STRAINERS AND VALVES

www.sureflowequipment.com



2010



FABRICATED SANITARY BASKET STRAINERS



Model - BW150SSTRI / BWA150SSTRI

Manufactured from 316 Stainless Steel and polished to 25 Ra with Teflon cover gaskets. Sure Flow Try Clamp Basket Strainers are intended for applications where frequent, thorough cleaning is required between every batch of product. Screening elements include perforation, mesh or wedge wire. Sanitary pressure gauge ports are available for mounting diaphragm seals.

Note: Other cover gasket material available upon request.

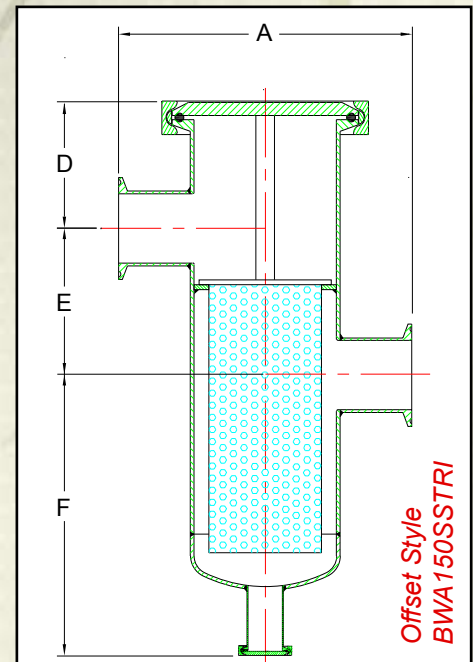
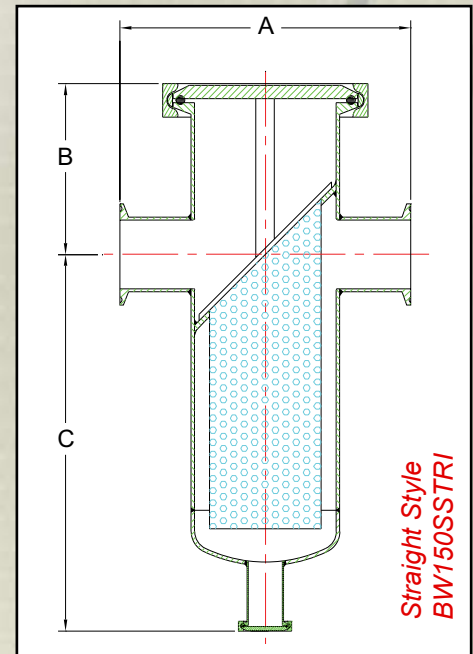

Dimensions (Inches)								
Size			A	B	C	D	E	F
Inches	Prefix	Body						
1/2	0050	4	7	3 1/2	6	3 1/2	2 1/2	3 1/2
3/4	0075	4	7	3 1/2	6	3 1/2	2 1/2	3 1/2
1	0100	4	7	3 1/2	6	3 1/2	2 1/2	3 3/4
1 1/2	0150	4	7	3 1/2	6	3 1/2	2 1/2	3 3/4
2	0200	4	7	3 1/2	6	3 1/2	3	4
2 1/2	0250	4	7	3 1/2	6	3 1/2	3 1/2	4 1/2
3	0300	6	10	5	11	5	5	6
4	0400	6	10	5	11	5	5	6

Larger sizes available.

Manufacturer reserves the right to modify dimensions, materials, or design. Contact factory for certification.

Ordering Information

Example: Include full description

Size
(Prefix)

0200

Model
Number

BW150SSTRI

Screen
Opening

125

Basket Strainer, Stainless Steel, 2" Sanitary Try Clamp with 1/8" Perforated basket.



**Sure Flow
Equipment Inc.**

Toll Free: 1-800-263-8251 Toll Free Fax: 1-800-876-1164
International: 1-905-335-1350 International Fax: 1-905-332-4993
Email: info@sureflowequipment.com www.sureflowequipment.com



FABRICATED SANITARY DUPLEX STRAINERS

Model - DB150SSTRI

The Sure Flow Equipment Try Clamp Duplex Strainer performs the same function as an industrial Duplex Strainer. The configuration can be changed to meet the specific application requirements.



Dimensions (Inches)			
Size		A	B
Inches	Prefix		
1/2	0050	24	6
3/4	0075	25	6
1	0100	27	6
1 1/2	0150	29	6
2	0200	32	6
2 1/2	0250	34	6
3	0300	38	11

Larger sizes available.

Manufacturer reserves the right to modify dimensions, materials, or design. Contact factory for certification.

Ordering Information

Example: Include full description

Size (Prefix)	Model Number	Screen Opening
0250	DB150SSTRI	125

*Dual Basket Strainer, Stainless Steel,
2 1/2" Sanitary Try Clamp with 1/8" Perforated basket.*

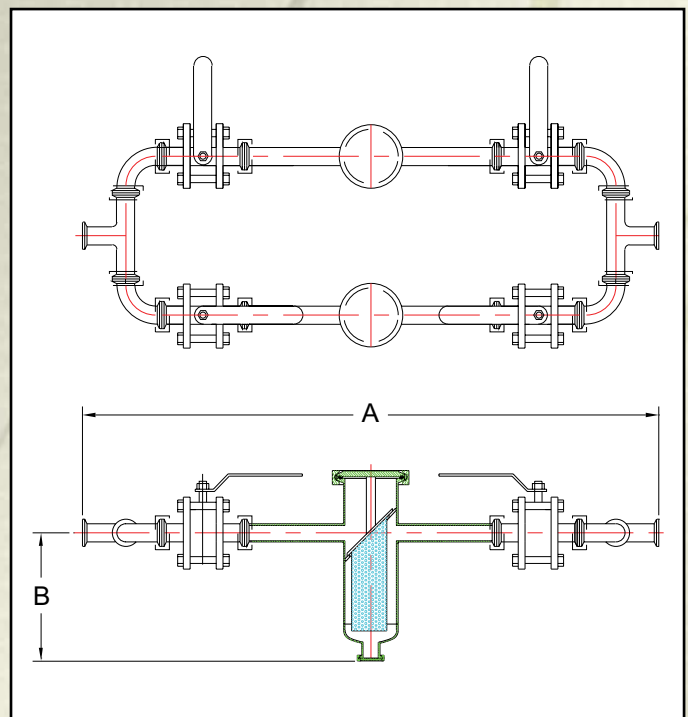

Sure flow
Equipment Inc.

Toll Free: 1-800-263-8251 Toll Free Fax: 1-800-876-1164
International: 1-905-335-1350 International Fax: 1-905-332-4993
Email: info@sureflowequipment.com www.sureflowequipment.com



SANITARY BUTTERFLY VALVES



Model - BFVTCSE

Sure Flow Equipment Sanitary Butterfly Valves are suitable for isolation or control. They are field repairable.

- Compact - Lightweight
- Easy assembly and disassembly
- Low pressure drop
- Pneumatic actuator available

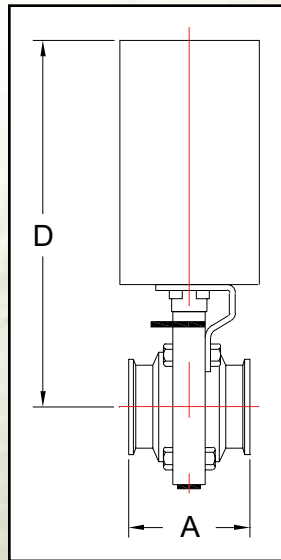

Construction

Material : Stainless Steel AISI-316
 Seat Material : EPDM
 Inside Surface Finish : 8 Ra Mirror Polish
 Outside Surface Finish : 25 Ra or better
 Maximum Pressure : 110 psi (8 bar)
 Maximum Temperature : 248 °F (121 °C)
 Options : Double Acting or Spring Return Pneumatic Actuator



Dimensions (Inches)					
Size					
Inches	Prefix	A	B	C	D
1	0100	2 11/16	3 3/16	5 3/16	8 3/4
1 1/2	0150	2 13/16	3 1/4	5 3/16	9
2	0200	2 15/16	3 3/4	6 1/8	9 5/16
2 1/2	0250	3 1/8	4 1/8	6 1/8	9 11/16
3	0300	3 1/8	4 3/8	6 1/8	10
4	0400	3 9/16	4 15/16	6 1/8	10 3/8

Larger sizes available.

Manufacturer reserves the right to modify dimensions, materials, or design. Contact factory for certification.

Ordering Information

Example: Include full description

Size	Model	
(Prefix)	Number	Actuation
0200	BFVTCSE	LVP

2" Sanitary Butterfly Valve with Multi-position Lever

LVP: Multi-position Lever Handle
 ACT: Double Acting Pneumatic Actuator
 ACTS: Spring Return Pneumatic Actuator

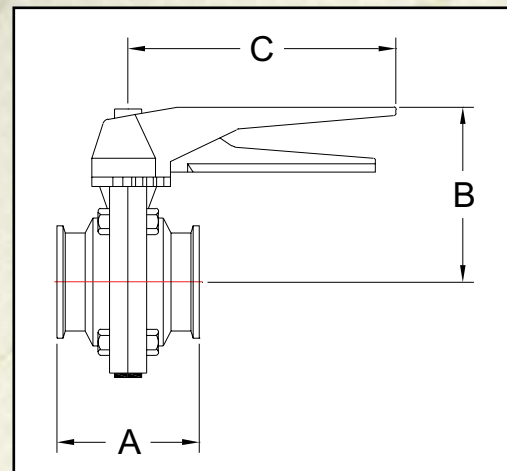

Sure Flow
 Equipment Inc.

Toll Free: 1-800-263-8251 Toll Free Fax: 1-800-876-1164
 International: 1-905-335-1350 International Fax: 1-905-332-4993
 Email: info@sureflowequipment.com www.sureflowequipment.com



SANITARY CHECK VALVES



Model - SSC150TC

The Sure Flow Equipment Sanitary Check Valves have been designed especially for the food, pharmaceutical, cosmetic and chemical industries. No product entrapment areas, avoiding bacteriological development - when properly installed.

- Full bore
- Easy disassembly, without tools
- Body is machined from solid bar
- Surface finishes are 25 Ra or better
- Low pressure drop

Construction

Body and Spring Material : 316L Stainless Steel
 Seat Material : EPDM
 Body Gasket : EPDM

Dimensions (Inches)			
Size			
Inches	Prefix	A	B
1	0100	4 1/8	3 7/16
1 1/2	0150	4 1/8	3 7/16
2	0200	4 5/16	3 15/16
2 1/2	0250	5 5/16	4 1/2
3	0300	5 15/16	5 1/8
4	0400	6 1/8	6 1/2

Larger sizes available.
 Manufacturer reserves the right to modify dimensions, materials, or design. Contact factory for certification.

Ordering Information

Example: Include full description

Size
(Prefix)

0200

Model
Number

SSC150TC

2" Sanitary Check Valve

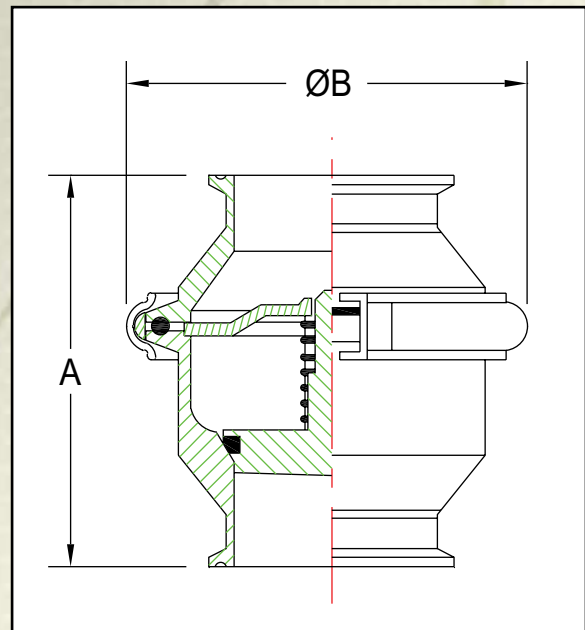



**Sure Flow
Equipment Inc.**

Toll Free: 1-800-263-8251 Toll Free Fax: 1-800-876-1164
 International: 1-905-335-1350 International Fax: 1-905-332-4993
 Email: info@sureflowequipment.com www.sureflowequipment.com

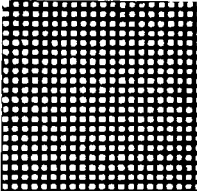
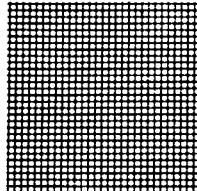
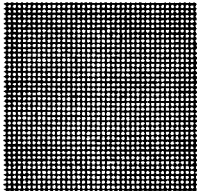
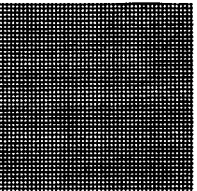
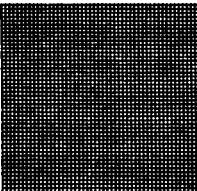

PERFORATED MATERIAL AND MESH

Mesh (Available In All Materials)

1/32" Openings	1/50" Openings	1/64" Openings	0.009" Openings	0.007" Openings	0.005" Openings
					
20 Mesh (46% Open Area)	30 Mesh (41% Open Area)	40 Mesh (36% Open Area)	60 Mesh (31% Open Area)	80 Mesh (31% Open Area)	100 Mesh (30% Open Area)

Mesh sizes other than shown - available on request

Perforated Plate (Available In All Materials)

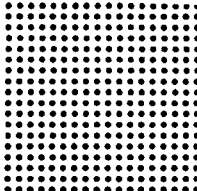
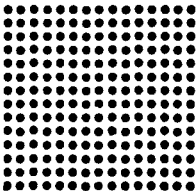
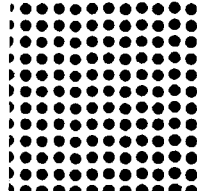
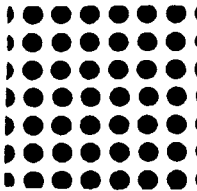
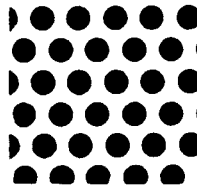
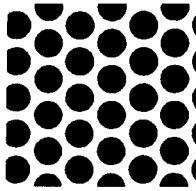
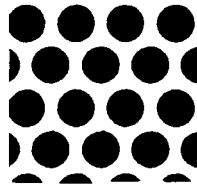
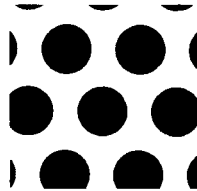
1/32" Dia. (0.032)	3/64" Dia. (0.045)	1/16" Dia. (0.062)	3/32" Dia. (0.094)
			
324 Holes/Sq. In. (28% Open Area)	225 Holes/Sq. In. (36% Open Area)	144 Holes/Sq. In. (41% Open Area)	47 Holes/Sq. In. (33% Open Area)
1/8" Dia. (0.125)	5/32" Dia. (0.156)	3/16" Dia. (0.188)	1/4" Dia. (0.25)
			
32 Holes/Sq. In. (41% Open Area)	33 Holes/Sq. In. (63% Open Area)	18 Holes/Sq. In. (51% Open Area)	8 Holes/Sq. In. (42% Open Area)

Mesh - Inch - Micron Conversion Chart

Meshes/Lineal Inch US and ASTM	Actual Opening	
Std. Sieve No.	Inches	Microns
10	.075	1905
12	.060	1524
14	.051	1295
16	.045	1143
18	.039	991
20	.034	864
24	.028	711
30	.020	508
35	.018	457
40	.015	381
50	.011	279

Meshes/Lineal Inch US and ASTM	Actual Opening	
Std. Sieve No.	Inches	Microns
60	.009	229
70	.008	203
80	.007	178
100	.006	152
120	.0046	117
130	.0043	109
140	.0042	107
150	.0041	104
160	.0038	97
170	.0035	89
180	.0033	84

Meshes/Lineal Inch US and ASTM	Actual Opening	
Std. Sieve No.	Inches	Microns
200	.0029	74
250	.0024	61
300	.0018	46
400	.0015	38
120 x 400	.0016	40
80 x 700	.0012	30
200 x 600	.0010	25
165 x 1400	.0007	17
200 x 1400	.0004	10
325 x 2300	.0002	5



**Sure Flow
Equipment Inc.**

Toll Free: 1-800-263-8251 Toll Free Fax: 1-800-876-1164
International: 1-905-335-1350 International Fax: 1-905-332-4993
Email: info@sureflowequipment.com www.sureflowequipment.com



SURFACE FINISHES

Surface Finish Chart				
Finish Number	Common Name	Grit Number	Ra (Microinch)	Description
# 1	Mill Plate (Hot Rolled)	N/A	N/A	A rough, dull surface appearance with most of the mill scale removed by pickling. This finish applies to all plate products 3/16" and thicker.
# 2	Satin Sheet (2B Mill)	N/A	N/A	A smooth, bright, moderately reflective finish available only in 1/4" or thinner sheet material (gauge thickness). Polishing after welding is not typical.
# 3	Semi-Polished	100 to 120	52	This finish is obtained with abrasives approximately 100 to 120 mesh with a pronounced grit line which may or may not be additionally polished during fabrication.
# 4	Commercial # 4	120	40 to 60 Typ.	This finish is a general purpose sanitary polished finish widely used for pharmaceutical applications, dairy equipment, restaurant equipment, etc. Following initial grinding with coarser abrasives, sheets are generally finished last with abrasives approximately 120 to 150 grit.
# 4	3A Sanitary	150	42 Maximum	
			30 to 35	
# 4	Sanitary Finish	180	30 Maximum	Used in the Medical and Food industries.
			20 to 30	
# 4S	"Bio-tech"	200 to 220	25 Maximum	Ultra high sanitary surface finish.
			15 to 20	
# 6	Satin Finish	240	15 to 20	A dull satin finish having lower reflectivity than a # 7 finish.
# 7	Bright Polish	320	12 Maximum	This finish has a high degree of reflectivity. It is produced by buffing of finely ground surface, but the grit lines are not removed.
			8 to 12	
# 8	Mirror Finish	400	4 to 8	The most reflective finish that is produced. It is obtained by polishing with successively finer abrasives and buffing extensively with very fine buffing rouges with the help of electro-polishing. The surface is essentially free of grit lines from preliminary grinding operations.
# 8	Super Mirror Finish	500	4 Maximum	



**Sure Flow
Equipment Inc.**

Toll Free: 1-800-263-8251 Toll Free Fax: 1-800-876-1164
International: 1-905-335-1350 International Fax: 1-905-332-4993
Email: info@sureflowequipment.com www.sureflowequipment.com





www.sureflowequipment.com

Sure Flow Equipment Inc. – Limited Warranty

All products are warranted to be free of defects in material and workmanship for a period of one year from the date of shipment, subject to below. **All custom products are not subject to return, credit or refund.**

If the purchaser believes a product to be defective, the purchaser shall:

- Notify the manufacturer **within ten (10) days after receipt of merchandise**, state the alleged defect and request permission to return the product. Merchandise will not be accepted for return without a "Return Code" clearly marked on the outside of the package. Contact the office to obtain a return code. **Merchandise will not be accepted for return or credit later than six (6) months after invoicing.**
- If permission is given, return the product with the transportation prepaid. Collect shipments will not be accepted. Goods must be returned **prepaid**.

If a shipment is received in a damaged or deficient condition, a claim must be filed with the delivering carrier and noted on the freight bill before you accept the merchandise. All other claims must be made in writing and received by Sure Flow Equipment Inc. within ten (10) days after receipt of merchandise.

If the product is accepted for return and found to be defective, the manufacturer will, at its discretion, either repair or replace the product, F.O.B. factory, within 60 days of receipt, or issue credit for the purchase price.

Sure Flow Equipment Inc. shall not be liable for failure to deliver or delays in delivering occasioned by acts of God, war, labor difficulties, inability to obtain materials or any other causes whatsoever beyond our control.

Other than to repair, replace or credit as described above, purchaser agrees that manufacturer shall not be liable for any loss, costs, expenses, or damages of any kind arising out of the product, its use, installation or replacements, labeling, instructions, information or technical data of any kind, description of product use, sample or model, warnings or lack of any of the foregoing.

NO OTHER WARRANTIES, WRITTEN OR ORAL, EXPRESS OR IMPLIED, INCLUDING THE WARRANTIES OF FITNESS FOR A PARTICULAR PURPOSE AND MERCHANTABILITY, ARE MADE OR AUTHORIZED. NO AFFIRMATION OF ACT, PROMISE, DESCRIPTION OF PRODUCT OR USE OR SAMPLE OR MODEL SHALL CREATE ANY WARRANTY FROM MANUFACTURER, UNLESS SIGNED BY THE PRESIDENT OF MANUFACTURER.

CANCELLATIONS:

Cancelled orders will be subject to a charge of at least 35%.

MINIMUM BILLING: \$100.00 NET

Cancelled custom orders will be subject to a charge of 100% of quoted price.

SPECIAL DOCUMENTATION:

A charge will apply for non-standard, special documentation requests such as Material Test Reports (MTR's) and Certificates of Conformance (COC's).



5010 North Service Rd.
Burlington, ON L7L 5R5
Tel: 905-335-1350 Fax: 905-332-4993



P.O. Box 321
Tonawanda, NY 14151-0321
Tel: 1-800-263-8251 Toll Free Fax: 1-800-876-1164

Email: info@sureflowequipment.com
Web Site: www.sureflowequipment.com

January 2010

